

People have always used and radically transformed their environment and landscape. The landscape is perceived as the highest value of the particular area. The house stands on the border of the village Troskovice (Czech Republic) - on the edge of the planned built-up area. This border (between the village and the wood) is seen as a turning point - not only of the landscape, but of the border too. The proposal uses the landscape as a forming element. The object hides under the ground to provide nice comfort for living with minimal maintenance, privacy (that is why we locate the house to the village), a sense of security and all that with regard to the ecology of the country.

There are three openings bringing light to the house. They are based on a different principle: 1) entrance, 2) terrace and 3) courtyard. This creates simple terraces. The solution offers the active use of roof surfaces. The building has two floors, divided by a half-floor.

Materials: Exterior - concrete, soil, interior: concrete, wood.

08 HOUSE IN PROTECTED LANDSCAPE AREA

PLACE: TROSKOVICE, ČEKÝ RÁJ
LEADER: DOC. MIROSLAV MELENA
2ND YEAR, FACULTY OF ART AND ARCHITECTURE, TUL LIBEREC CITY

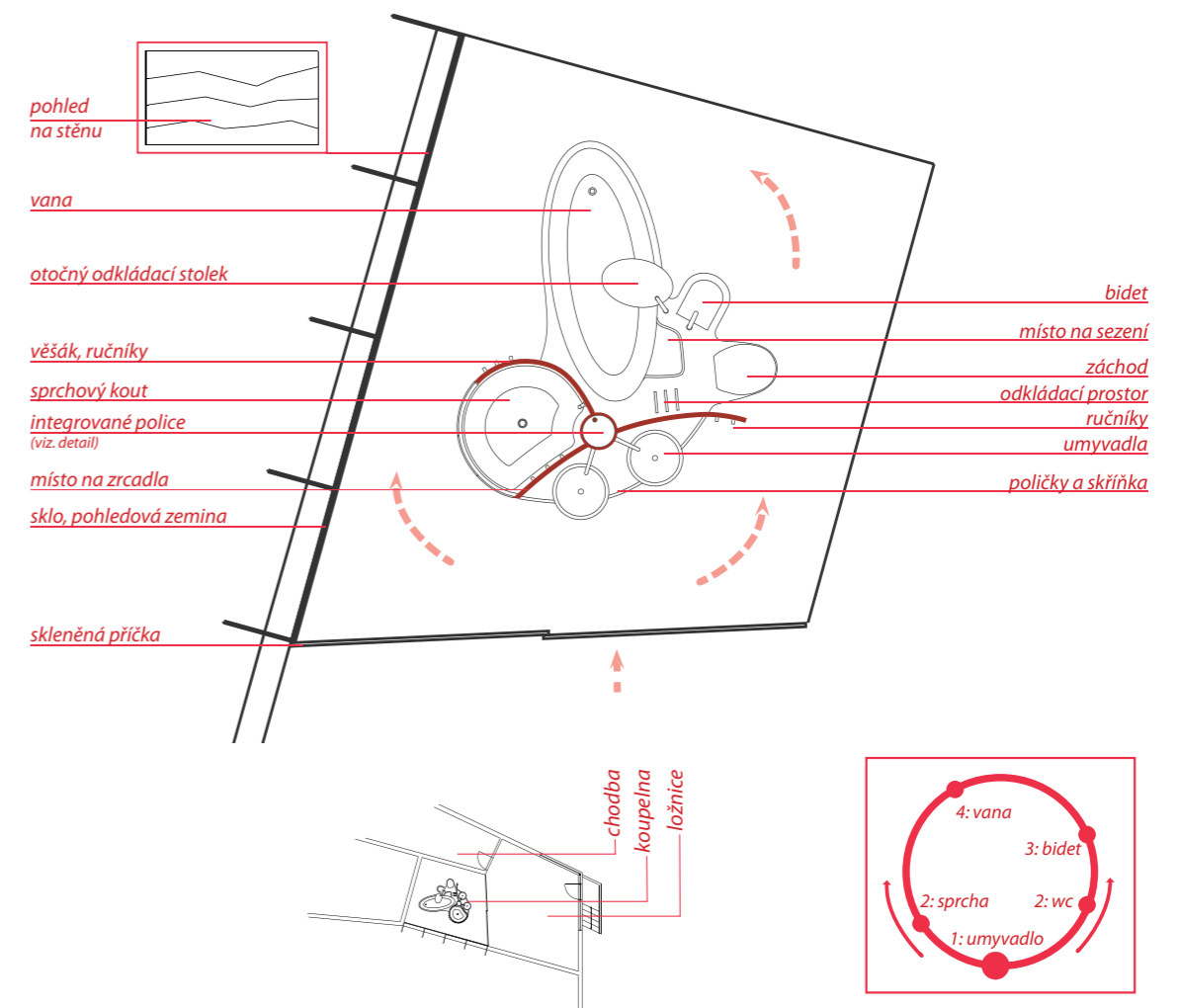
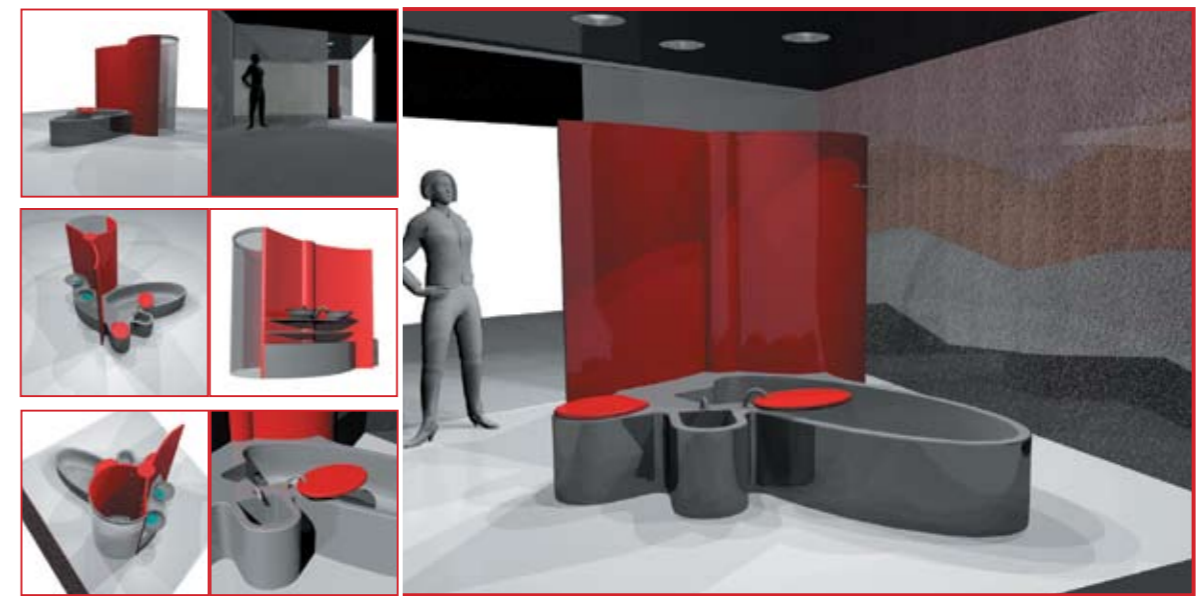

09 BATHROOM

DESIGN OF BATHROOM; HOUSE UNDERGROUND IN PLA
LEADER: ING. ARCH. AKAD. ARCH. JAN HENDRYCH
2ND YEAR, FACULTY OF ART AND ARCHITECTURE, TUL LIBEREC CITY