

2003

2004

2005

2006

2007

2008

2009

2010

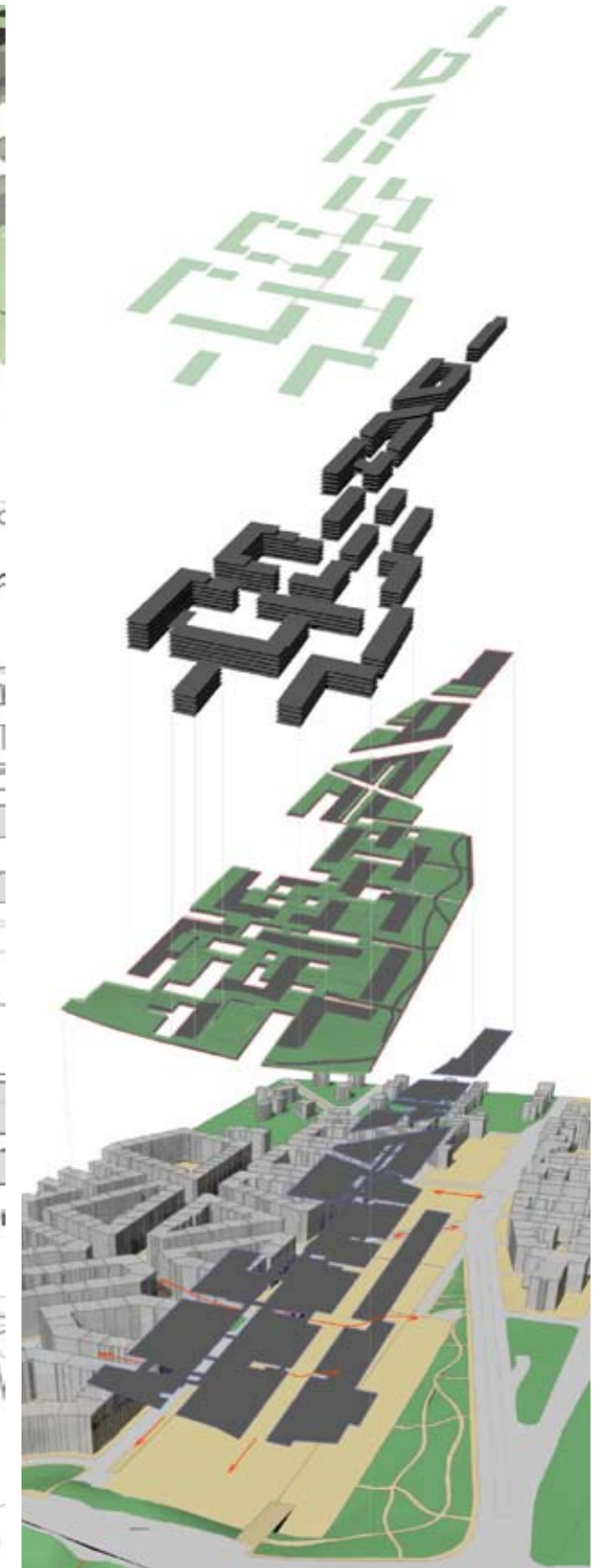
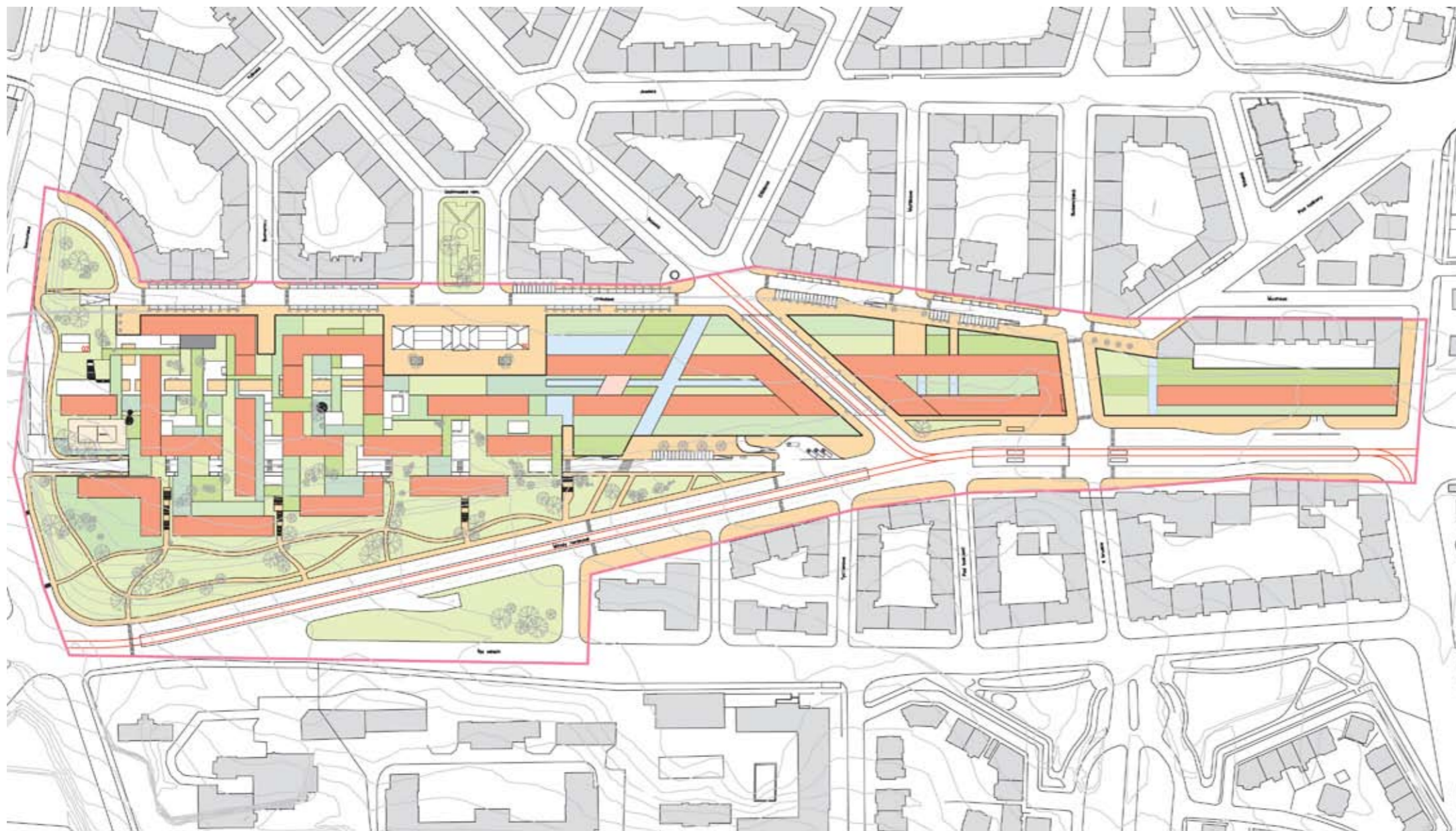
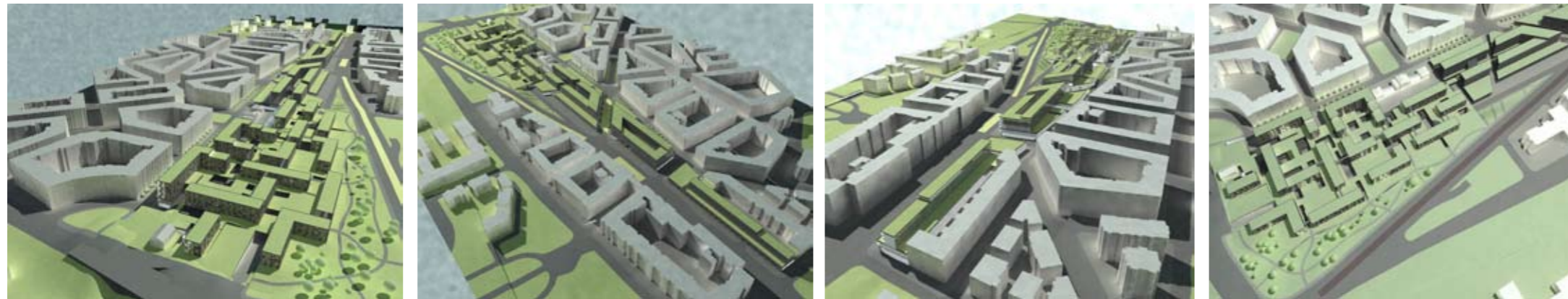

15 EUROPAN - CZ -9 / BACHELOR THESIS

PLACE: PAGUE, DEJVICE - HRADČANSKÁ, ŠPEJCHAR
 LEADER: DOC. ING. ARCH. JÁN STRCULA
 4TH YEAR, FACULTY OF ART AND ARCHITECTURE, TUL LIBEREC (CZECH)

2003

2004

2005

2006

2007

2008

2009

2010

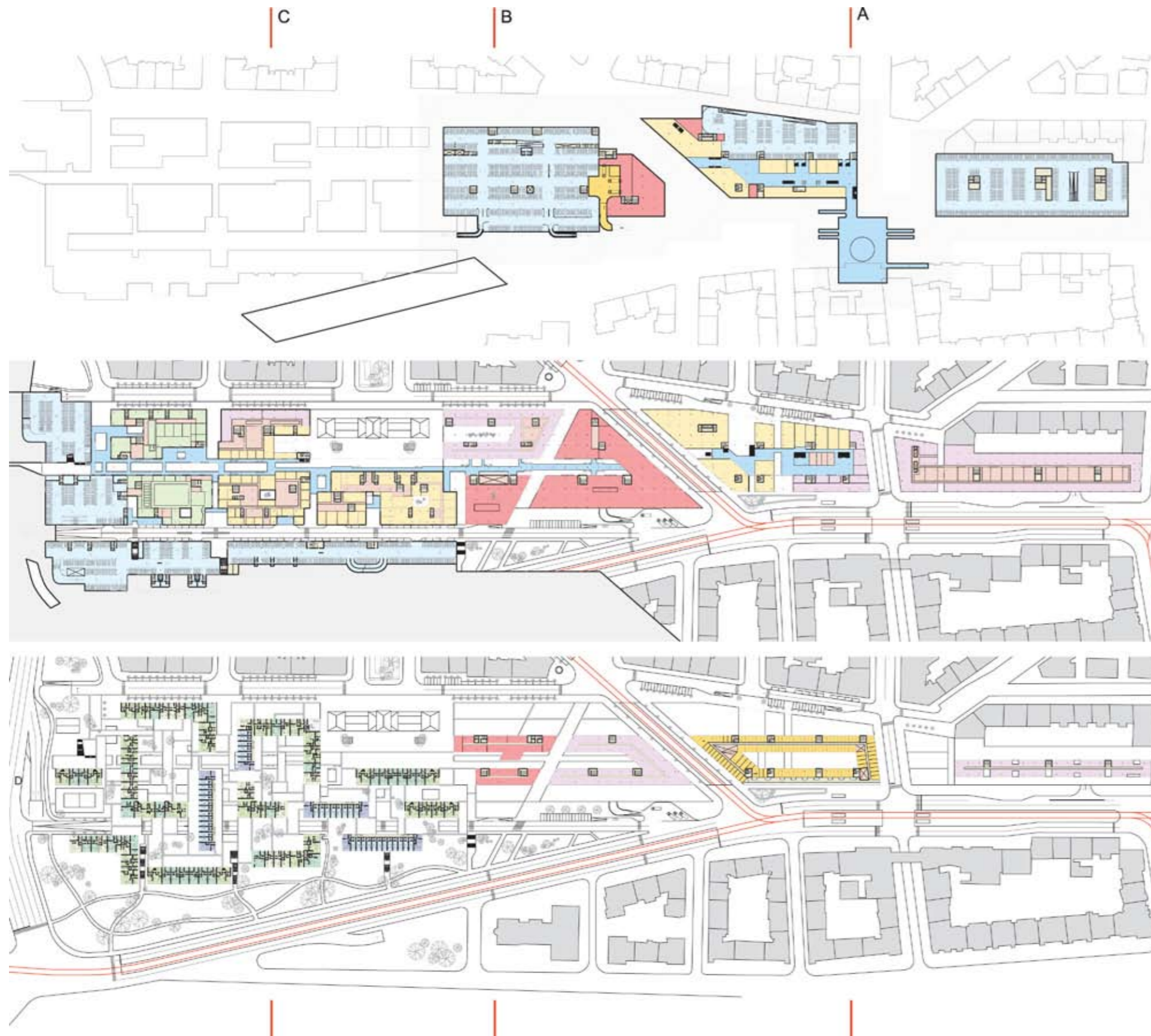

The resulting Urbanism is a fusion of several influences that I have gathered in a couple of principles. I am convinced that a functioning urban environment should not reduce the existing influences, but rather redefine them and create necessary environment for diverse and often contradictory demands.

Longitudinal direction – rails and wedge (V-Z)

Longitudinal direction is primarily linked to linearity, which for a long time has been - and still is - defined by the railway. The rails act as an expressive element dividing the two different worlds. I wanted the original (and partly also the new) designation of the space to be evident. Just like the rails at the train station, here also the houses branch out, in the east-west direction. "Switches" are formed, narrow houses disintegrate and crumble. Rapid movement slows down from the East and comes to a standstill. The objects "arrive" to the lot, trying to wedge in, to solidify the space. The movement causes also a gradual change of the function of buildings: it starts at the junction, in a spot where the highest accumulation of people and traffic is expected (fast movement), towards the West the buildings gradually change their function, from the terminal with a hotel, past the administration (city offices), to the residential area - here the movement stops completely. In the longitudinal direction the project should be read from the East to the West, like a train stopping at the station.

Lateral direction - linking (S-J)

The lateral direction tries to link with the neighbourhood. Here I leave to imprint loosely the original (historical) street lines, shapes of surrounding buildings. These in places of imaginary continuation of the buildings cut through the objects, creating trough views mostly on the Prague Castle. Dejevice blocks of houses gradually disintegrate and merge into scattered build-up area.

Vertical direction - three layers - the city, free housing, outlook

In the solution I used the site of inappropriate northern falling and proposed a new level terrain park and defined the space for residential buildings. It hides urban structure (with which it does not lose contact thanks to through views) and creates a park area, from which blocks stand out like solitaires. The whole "green board" ends at the border of the Václavkova Street, where its height completes the parterre of the street, which already has a lively pedestrian life. The buildings above the parterre deliberately retreat, so that their height does not impede the view or solarly of existing build-up area of the Dejevice quarter.

The green space vertically divides the area into two worlds. Urban environment with open arcades, galleries, shops and services below, above it solitary apartment buildings, whose composition creates internal semi-private courts – parks with a desire for positive social climate (a sense of neighbourhood). The quantity of greenery will also have a positive impact on psychological well-being of humans and the environment and will ensure versatility during the year. The same principle, albeit to a limited extent, is applied in the eastern part of the land where from a broader parterre mass protrude narrow houses which therefore do not overshadow the existing housing and receive adequate backlighting. The lower part is in this way directly linked to the existing block area of Dejevice, extending its streets, creating small open areas and sufficiently dense urban environment with human scale and plenty of space for commercial activity.

Last layer - view – runs through the green roofs of residential buildings. The roofs become entirely private parts of exclusive gardens overlooking both Dejevice and Prague Castle.

Traditional block - free housing

When addressing this area I had thought at length about the theme of a backyard (Engel urbanism) as a cornerstone of the Dejevice expression. The division into private (yard) vs. public (street), clearly defined blocks appearing as one house only. I was looking for connections between the dense and therefore lively city following-up the existing quality of Dejevice and apartment buildings backlitted by free urbanization.

2003

2004

2005

2006

2007

2008

2009

2010

